

# LOCATION MAP



RERA NO. RAJ/P/2024/2962



**Site Add.:- Plot No. 5 Corner, Arogya Near New Medical College & Hospital, Kota (Raj.)-324005**

## Location Advantage:-

- ▲ Situated at Arogya nagar just near to New medical College & Hospital kota.
- ▲ Corner plot with two side wide roads.
- ▲ Rajasthan technical University, kota university, V.M.O.U. proximity to the project.
- ▲ Reputed c.b.s.e schools Bansal public school and disha delphi public school are near to the project.
- ▲ Khade Ganesh ji temple & Ganesh udyan are just near by.
- ▲ Approx 1.2 km from ghatotkach circle.
- ▲ Approx 1.6 km from mahaveer nagar circle.

BUILDER & DEVELOPERS:



CORPORATE OFFICE:

**Sumangalam Groups**  
 Add. :- 142-A, Shrinathpuram, Near Bsnl Circle  
 Kota(Raj)-324001  
 email: info@sumangalambuildmart.com  
 Web:- shubhambrosia.com

ARCHITECT:

**PRIME ART**  
 ARCHITECTS (P) LTD  
 CREATING DIMENSIONS  
 Mob. : +91 98281 37800  
 Web. : www.primeartarchitects.com  
 E-mail :primeartarchitects@gmail.com

**For Booking Contact: 9649908036**

Disclaimer:

The Project Consultant has the rights to change the plans, design & specifications or revise the scheme as & when necessary as per by laws and designer's convenience.

This Brochure is not to be treated as part of the documents. It is only for easy display and information/ instruction regarding the Project.



# GROUND FLOOR PLAN

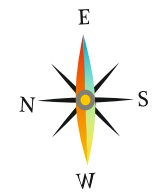

# FIRST FLOOR PLAN

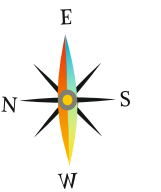

# TYPICAL FLOOR PLAN

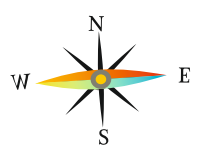



4

BHK | UNIT FLOOR PLAN

BUILTUP AREA=1736.70 SQ FT  
SALABLE AREA=2481.0 SQ FT



KEY PLAN

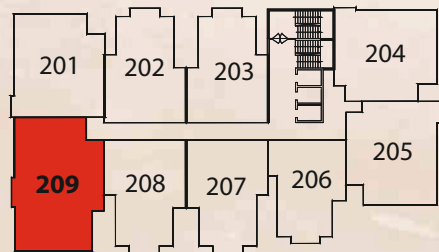

3

TYPE 01  
BHK | UNIT FLOOR PLAN

BUILTUP AREA=1430.76 SQ FT  
SALABLE AREA=2044 SQ FT



KEY PLAN

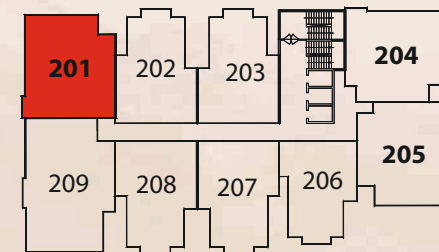

# 3

## TYPE 02 BHK | UNIT FLOOR PLAN

BUILTUP AREA=1255.00 SQ FT  
SALABLE AREA=1793.00 SQ FT



KEY PLAN

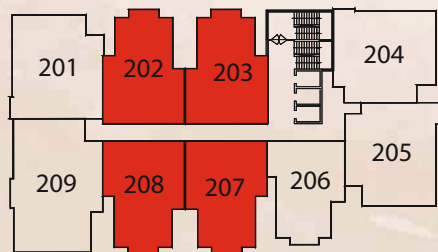

# 3

## TYPE 03 BHK | UNIT FLOOR PLAN

BUILTUP AREA=1056.75 SQ FT  
SALABLE AREA=1509.00 SQ FT



KEY PLAN

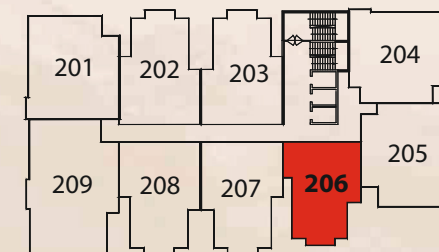

# 3

TYPE 04  
BHK | UNIT FLOOR PLAN  
BUILTUP AREA=1415.00 SQ FT  
SALABLE AREA=2021.00 SQ FT



KEY PLAN

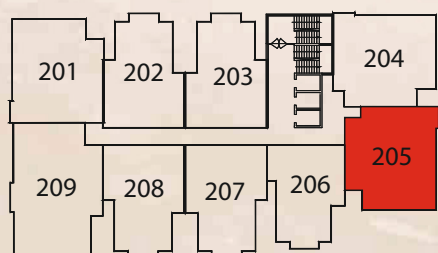

## Project Highlights/Features :-

- ▲ Earthquake Resistant Framed Structure
- ▲ Functional Design With Pleasant Architecture
- ▲ Designed to ensure maximum light and cross ventilation
- ▲ Offering apartments in 3 & 4 bedroom configurations.
- ▲ High speed Elevators
- ▲ Power Backup( Silent Dg Set) For Common Areas .
- ▲ C.C T.V Security System in common areas
- ▲ Security by professional agencies round the clock
- ▲ Efficient Fire Fighting system
- ▲ Rain Water Harvesting System
- ▲ Well Planned car Parking Spaces
- ▲ World class construction chemicals/Admixtures
- ▲ Premium quality Electric switches & accessories
- ▲ Premium quality bathroom fittings

## Amenities :-

- ▲ High tech & well equipped Clubhouse
- ▲ Air Conditioned Multipurpose Hall
- ▲ Entrance Lobby
- ▲ Well Equipped Gymnasium
- ▲ Mini Theater
- ▲ Swimming pool
- ▲ Kids pool
- ▲ Indoor Games
- ▲ Chess and Carrom Room
- ▲ Pool Table
- ▲ Table Tennis
- ▲ Guest Room
- ▲ C.C T.V Security System in common areas
- ▲ Round the Clock Security by Modern Sec
- ▲ Well Planned car Parking Spaces



## Specifications :-

### BEDROOMS

- Floor : Premium Class Flooring of Vitrified Tiles in all Bedrooms
- Walls : Acrylic Emulsion Paint on Putty (Asian/ Nerolac or Equivalent)
- Ceiling : Acrylic Emulsion Paint on Ceiling
- Door & Windows : Wooden / UPVC Door Windows

### KITCHEN

- Counter : Granite Working Counters
- Fitting/ Fixtures : CP Fittings With Stainless Steel Sink, Provision for RO/Aquaguard Electric Points for Microwave/Mixer, Refrigerators etc. wall tiles 2' Tiles Dado Above the Counter Acrylic Emulsion Paint in Balance Area.
- Floor : Vitrified tiles
- Ceiling : Acrylic Emulsion Paint on Ceiling
- Style : Modular Kitchen With Chimney
- Wash Area : Separate Washing Area

### BALCONIES

- Floor : Anti skid Ceramic Tiles
- Ceiling : Acrylic Emulsion Paint on Ceiling
- Doors & Windows : UPVC / Aluminum Door Windows.

### LIVING/ DINING

- Floor : Premium Vitrified Tiles
- Walls : Acrylic Emulsion Paint on Putty (Asian/ Nerolac or Equivalent)
- Ceiling : Acrylic Emulsion Paint on Ceiling
- Services : Provision for Air Conditioners
- Door & Windows : Wooden / UPVC Door Windows

### TOILET

- Walls : Combination of Ceramic Tile and Acrylic Emulsion Paint
- Floor : Anti Skid Ceramic Tiles.
- Ceiling : Acrylic Emulsion Paint on Ceiling
- Fixtures/ Assess : C.P Fitting Premium Brand or Equivalent
- Doors : Tough ISI Mark Flush Doors
- Provisions : Provision for Geyser and Exhaust Fan

## OUR PROJECTS

